

VENUES

at WCG

conferencing • events • meeting rooms

FLEXIBLE & CONVENIENT VENUES FOR BUSINESS & EVENTS



wcg.ac.uk/venues

CONTENTS

Venues @ Rugby College 4

Venues @ Warwick Trident College 8

Additional rooms, facilities and spaces available within WCG 12

WCG in Warwickshire 14

Testimonials 15



WELCOME TO VENUES @ WCG

A college group may not spring to mind immediately as a conference and events venue for your business, but with a number of dedicated spaces which were developed for exactly that purpose, we think you'll be pleasantly surprised by what we have to offer.

If you are looking for flexible and spacious conference or events facilities, with the support and expertise to handle all types of event requirements, all within convenient distance of major roads and railway stations, then you will find them with **Venues @WCG**.

In addition to tangible benefits such as free parking and a wide range of options to choose from, you have an additional advantage when you book a venue with WCG - every booking made contributes towards supporting the education of young people and adults across our group of colleges. So choosing **Venues @WCG** is one way in which you can contribute towards improving social mobility in the West Midlands.



VENUES

at RUGBY COLLEGE

conferencing • events • meeting rooms

RUGBY COLLEGE

Technology Drive, Rugby
Warwickshire, CV21 1AR

0330 135 6923

venues@wcg.ac.uk

A SPACIOUS & FLEXIBLE CONFERENCE VENUE

Rugby College's location, with easy access from road and rail, makes it an exceptional choice for events of all sizes, whether conferences and shows, business meetings, or private parties.

The Morgan Suite and the surrounding rooms and spaces were purpose built to host business events and private functions. Not only does the college offer a free private car park for guests, but the conferencing areas are extremely flexible, have their own entrance and lift access, and feature a bright and open balcony space.

Whatever specific needs event organisers and guests have, our dedicated events team can provide a bespoke package at an affordable price. So, if you're planning an event and want a venue that you can have genuine confidence in, contact us today and see how we can help.

GREAT CONNECTIVITY

- 2 mins from Rugby Railway Station – a key stop on the West Coast mainline and well-linked to other UK cities and Midlands destinations
- 6 mins from J1 of the M6
- 15 mins from M45 which connects to the M1
- Ample free parking at Rugby College for all your delegates or attendees

THE MORGAN SUITE

The impressive Morgan Suite can accommodate over two hundred guests as a single conference venue, but has the flexibility to be transformed into three large meeting or event rooms. This makes it ideal for functions that may benefit from a variety of room set-ups or which require separate break-out areas.

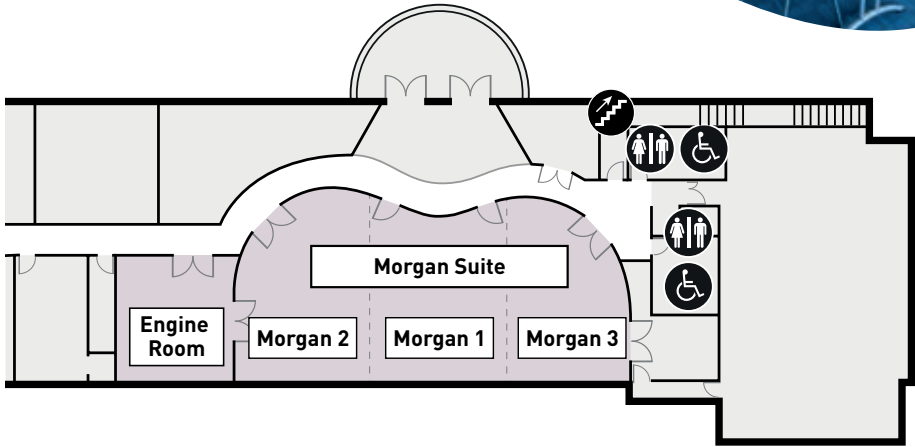

THE ENGINE ROOM

Adjoining the Morgan Suite, this spacious and modern meeting room accommodates a variety of layouts and is not only ideal for business meetings, but also suits workshops, seminars, and training sessions.

For large events hosted in the Morgan Suite, it is extremely useful as a breakout or catering area.



ROOMS AVAILABLE TO HIRE & CAPACITIES

Room	Dimensions (m)	Capacity				
		Theatre 	U-shape 	Boardroom 	Classroom 	Cabaret
Morgan 1	9.43 x 7.97	77	30	24	35	36
Morgan 2	10.76 x 7.95	64	26	24	35	36
Morgan 3	10.45 x 7.15	54	24	24	25	30
Morgan 1 & 2	10.76 x 15.9	140	N/A	N/A	70	72
Morgan 1 & 3	10.65 x 15.12	120	N/A	N/A	60	66
Morgan Suite	10.76 x 23.07	200	N/A	N/A	90	90
Engine Room	7.11 x 6.59	30	16	20	14	18
Classroom	Various	24	12	12	24	N/A

PRIVATE FUNCTIONS

Rugby College's accessibility and flexibility make it an affordable and attractive venue for private functions of all kinds, from birthday parties to wedding receptions. With on-site catering and a highly-experienced events management team, the college can deliver an event experience that will delight you and your guests.

- Wedding receptions
- Parties
- Buffets & sit-down dining

SPECIALIST VENUES

In addition to its dedicated spaces for conferencing and private functions, Rugby College's theatre, sports hall and astro-turf sports pitch can also be hired as specialist event venues.

Our theatre can be used as a fully-functional performing arts venue for workshops, training and speaking engagements, whilst our sports facilities have been used to host events ranging from team building days to puppet shows and Scalextric championships.

- Astro-turf pitch
- Sports hall
- Theatre
- Dance Studio



VENUES

at WARWICK TRIDENT COLLEGE

conferencing • events • meeting rooms

WARWICK TRIDENT COLLEGE

Poseidon Way, Royal Leamington Spa,
Warwick, CV34 6SW

0330 135 6923

venues@wgc.ac.uk

A PRESTIGIOUS VENUE FOR BUSINESS & INDUSTRY

Warwick Trident College has had a close association with business and industry since its foundation, and offers a professional environment for industry events and conferences.

It's location in the heart of the UK and ease of access from road and rail networks makes it an exceptional venue for businesses located around Leamington Spa, Warwick and beyond. It is also unusual amongst college venues because the Trident Suite and the surrounding event spaces were purpose built to host trade and industry functions.

Not only does the college offer a free private car park for guests, but the conferencing areas are extremely flexible in terms of layout and use.

Whatever specific needs event organisers and guests have, our dedicated events team can provide a bespoke package at an affordable price. So, if you're planning an event or meeting and want a venue that you can have genuine confidence in, contact us today and see how we can help.

GREAT CONNECTIVITY

- 12 mins from Royal Leamington Spa Station
- 10 mins from Warwick Station
- 7 mins from M40 Junctions 13 and 14
- Ample free parking at Warwick Trident College for all your delegates or attendees

THE TRIDENT SUITE

The impressive Trident Suite can accommodate up to two hundred guests as a single venue but has the flexibility to be transformed into two large meeting or event rooms.

This makes it ideal for functions that may benefit from different room set-ups or separate break-out areas.

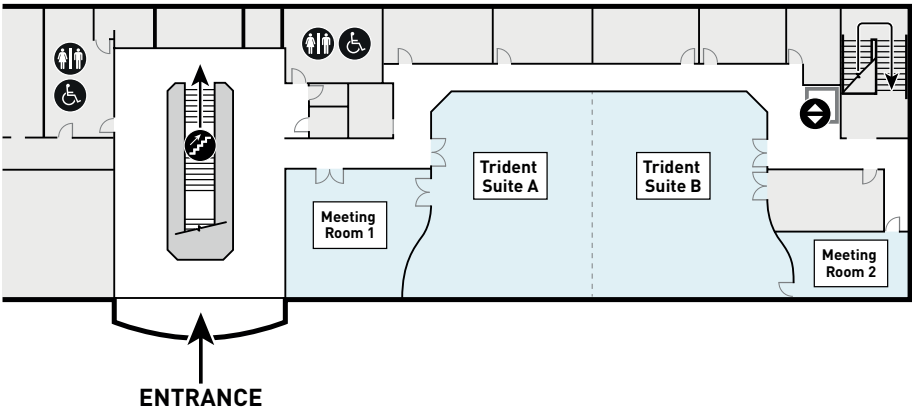

MEETING ROOMS

Warwick Trident College offers a selection of rooms that are suitable for business meetings of between ten and two hundred guests. Rooms are available for hire by the half day, catering can be provided, and I.T support is available.



ROOMS AVAILABLE TO HIRE & CAPACITIES

Room	Dimensions (m)	Capacity				
		Theatre 	U-shape 	Boardroom 	Classroom 	Cabaret
Meeting Room 1	6.63 x 7.45	40	16	20	12	28
Meeting Room 2	6.49 x 3.69	N/A	N/A	10	N/A	N/A
Trident Suite A	12 x 9.51	100	35	35	40	70
Trident Suite B	12 x 10.2	100	35	35	40	70
Trident Suite A & B	12 x 19.7	200	N/A	N/A	120	144
Classroom	Various	30	12	12	30	N/A

PRIVATE FUNCTIONS

Warwick Trident College's accessibility and flexibility makes it an affordable and attractive venue for private functions of all kinds, from birthday parties to wedding receptions.

With on-site catering and a highly-experienced events management team, the college can deliver an event experience that will delight you and your guests.

- Wedding receptions
- Parties
- Buffets & sit-down dining
- Leisure events



ADDITIONAL ROOMS, FACILITIES & SPACES AVAILABLE TO HIRE

WCG comprises six colleges across Warwickshire and Worcestershire and though Rugby and Warwick Trident are the two with dedicated conferencing and events facilities, we have other rooms, facilities and spaces at our other colleges which we are happy to discuss hiring out for events.

This includes:

**MORETON
MORRELL COLLEGE**
Warwickshire

- Equine indoor & outdoor arenas
- Fields
- Sports hall

**ROYAL LEAMINGTON
SPA COLLEGE**
Warwickshire

- Lecture theatre
- Classrooms
- Sports hall
- Atrium & mezzanine landings

**PERSHORE
COLLEGE**
Worcestershire

- Outdoor space
- Meeting rooms
- Classrooms

To discuss with us any of the above please contact us on the following:
venues@wcg.ac.uk | 0330 135 6923





WCG IN WARWICKSHIRE

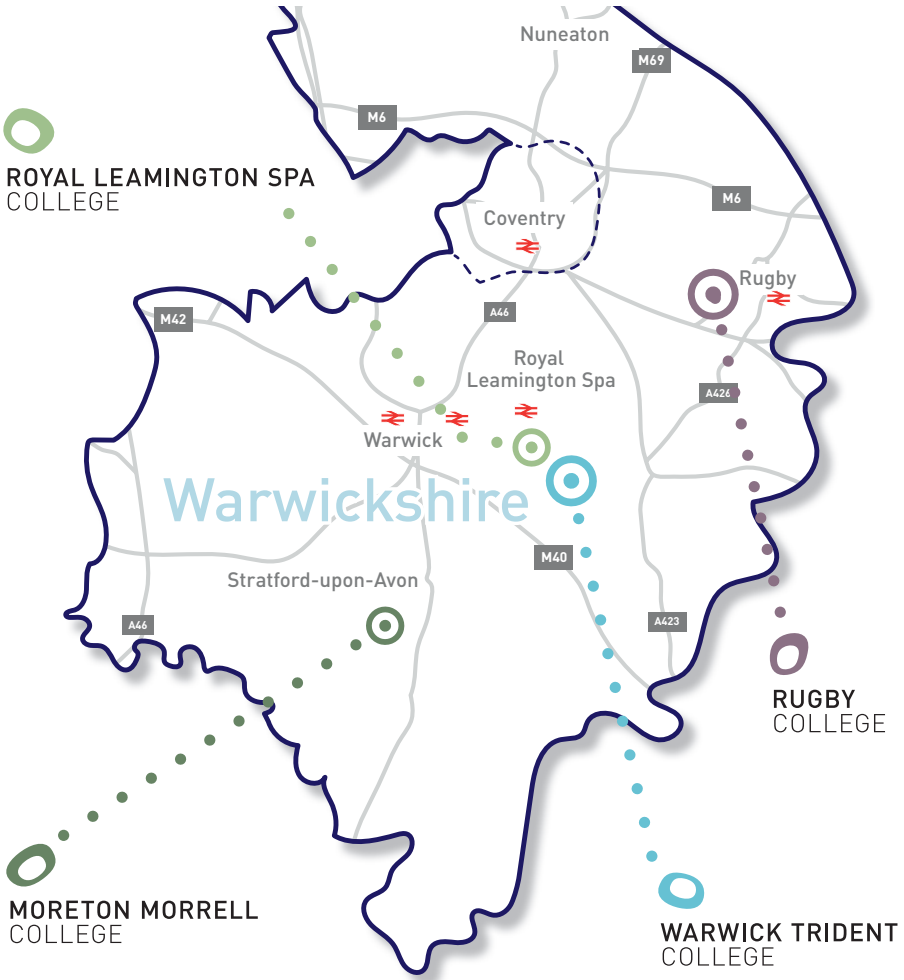

VENUES

at RUGBY COLLEGE

Technology Drive, Rugby
Warwickshire, CV21 1AR

@RugbyColWCG

@RugCollegeWCG

/RugbyCollege

VENUES

at WARWICK TRIDENT COLLEGE

Trident Park, Poseidon Way
Warwickshire, CV34 6SW

@TridentColWCG

@TriCollegeWCG

/WarwickTridentCollege

TESTIMONIALS



From the time you arrive you are looked after in a very professional and friendly way.

We have been using Rugby College for some years now and can say that they do it right. People, food, meeting rooms, service, nothing seems to be too much trouble. When you do ask for something special or a little out of the ordinary, the whole team is keen to help and assist. A perfect solution for our meetings.

Sophie Morley, Education Safeguarding Children



I find Warwick Trident College to be the very best value for money in Warwickshire.

It has excellent facilities, catering, and on-site parking. The staff are always welcoming, professional and provide a first-class service.

Highly recommended – five stars!

Paula Bentley, National Grid



May I say a big thank you for your hospitality at the weekend and special thanks also to the catering team.

I have received considerable positive feedback from the chess players who attended the event concerning the excellent quality of customer service and delicious food in the refectory. I look forward to meeting you all again soon and holding our next event at your venue.

Guy Greenland Congress Director, Warwickshire Chess Championships

VENUES

at RUGBY COLLEGE

Technology Drive
Rugby
Warwickshire
CV21 1AR

 @RugbyColWCG
 @RugCollegeWCG
 /RugbyCollege

VENUES

at WARWICK TRIDENT COLLEGE

Trident Park
Poseidon Way
Warwickshire
CV34 6SW

 @TridentColWCG
 @TriCollegeWCG
 /WarwickTridentCollege